

GENERAL INFORMATION

SHARKIE™

Wall Anchor

PRODUCT DESCRIPTION

The Sharkie wall anchor is engineered for strength in a variety of materials. During installation, the screw extrudes and compresses the anchor into the base material under pressure. The anchor molds and conforms to the surface of the hole. The forces supported by the screw are transmitted outwardly 360° providing good holding power by distributing the force over the maximum area possible. These fasteners are not recommended for use overhead or applications where holding values are critical.

GENERAL APPLICATIONS AND USES

- Electrical equipment
- Lighting fixtures
- Telephone equipment
- Alarms
- Towel dispensers
- Awnings
- Circuit breakers
- Window frames
- Fire extinguishers
- RTA furniture
- Soap dispensers
- Signs
- Bathroom partitions

FEATURES AND BENEFITS

- + Can be installed through the fixture with a screw gun
- + Anti-rotation fins and head design prevent sinking and spinning
- + Applicable to a variety of base materials
- + Works with a broad range of screw sizes for holding power without cracking base material
- + Corrosion-resistant polymer absorbs shock and vibration
- + Non-magnetic and non-conductive plastic body

INSTALLATION SPECIFICATIONS

Dimensions	07580 (Small)	07582 (Medium)	07584 (Large)
Drill Diameter (in.)	3/16	1/4	5/16
Screw Size Range (UNC)	No. 4 to No. 10	No. 6 to No. 12	No. 8 to No. 14
Approx. Anchor Length (in.)	1	1-3/16	1-5/8
Min. Hole Depth, Solid Base Materials	1-3/8	1-9/16	2
Min. Wall Thickness (in.)	1/4	3/8	1/2

1. In wallboard/drywall: a 10d nail or #1 Phillips screwdriver will suffice to make insertion hole for small anchors (07580); a #2 Phillips screwdriver will suffice to make insertion hole for medium anchors (07582); a #3 Phillips screwdriver will suffice to make insertion hole for large anchors (07584).
2. In solid base materials, the screw must be embedded the full length of the anchor. Suggested minimum screw length is the anchor length + fixture thickness. Total screw length should not exceed hole depth + fixture thickness in solid base materials. In hollow walls, minimum screw length = wall thickness + fixture thickness + 1/4"

INSTALLATION GUIDELINES

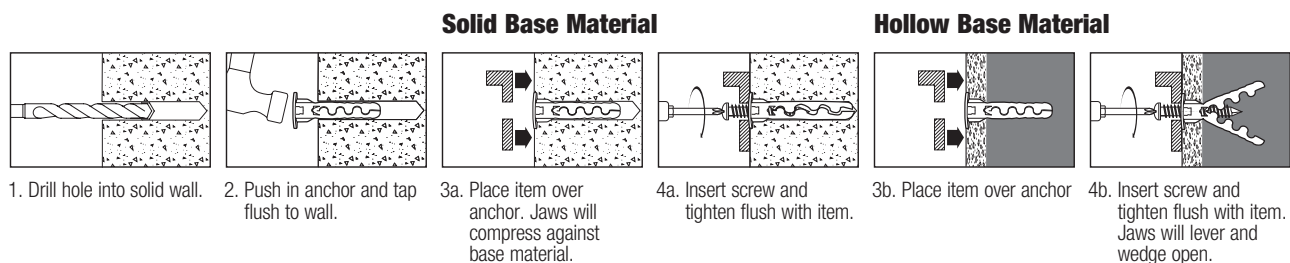

1. Drill hole into solid wall.

2. Push in anchor and tap flush to wall.

3a. Place item over anchor. Jaws will compress against base material.

4a. Insert screw and tighten flush with item.

3b. Place item over anchor

4b. Insert screw and tighten flush with item. Jaws will lever and wedge open.

SECTION CONTENTS

General Information..... 1
 Installation Guidelines..... 1
 Performance Data..... 2
 Ordering Information..... 3



SHARKIE

ANCHOR MATERIALS

- Engineered Plastic

ANCHOR SIZE RANGE (TYP.)

- No. 4 to No. 14 screws

SUITABLE BASE MATERIALS

- Concrete
- Brick
- Cinder Block
- Wood
- Masonry
- Ceramic Tile
- Plaster
- Stone
- Stucco
- Aerated Concrete
- Flakeboard
- Wallboard/Drywall

PERFORMANCE DATA

Ultimate and Allowable Capacities for Sharkie in Normal Weight Concrete^{1,2}

Anchor Size	Screw Diameter	2000 psi				4000 psi				6000 psi			
		Ultimate Load		Allowable Load		Ultimate Load		Allowable Load		Ultimate Load		Allowable Load	
		Tension lbs.	Shear lbs.	Tension lbs.	Shear lbs.	Tension lbs.	Shear lbs.	Tension lbs.	Shear lbs.	Tension lbs.	Shear lbs.	Tension lbs.	Shear lbs.
#4-#10 (small)	#6	350	245	90	60	380	245	100	60	410	245	105	60
	#8	415	405	105	100	430	405	110	100	445	405	110	100
#6-#12 (medium)	#8	220	365	55	90	220	365	55	90	220	365	55	90
	#10	415	460	105	115	415	460	105	115	415	460	105	115
#8-#14 (large)	#10	370	490	95	125	370	490	95	125	370	490	95	125
	#12	450	735	115	185	450	735	115	185	450	735	115	185

1. Allowable load capacities listed are calculated using an applied safety factor of 4.0.
2. These fasteners are not recommended for use overhead or applications where holding values are critical.

Ultimate and Allowable Capacities for Sharkie in Grouted Concrete Masonry^{1,2}

Anchor Size	Diameter Screw	Face				Bed Joint			
		Ultimate Load		Allowable Load		Ultimate Load		Allowable Load	
		Tension lbs.	Shear lbs.	Tension lbs.	Shear lbs.	Tension lbs.	Shear lbs.	Tension lbs.	Shear lbs.
#4-#10 (small)	#6	300	225	60	45	300	160	60	30
	#8	410	400	80	80	300	285	60	55
#6-#12 (medium)	#8	235	340	45	70	200	335	40	65
	#10	435	480	85	95	360	390	70	80
#8-#14 (large)	#10	385	420	75	85	300	335	60	65
	#12	500	600	100	120	360	390	70	80

1. Allowable load capacities listed are calculated using an applied safety factor of 5.0.
2. These fasteners are not recommended for use overhead or applications where holding values are critical.

Ultimate and Allowable Capacities for Sharkie in Hollow Concrete Masonry^{1,2,3}

Anchor Size	Diameter Screw	Face				Bed Joint			
		Ultimate Load		Allowable Load		Ultimate Load		Allowable Load	
		Tension lbs.	Shear lbs.	Tension lbs.	Shear lbs.	Tension lbs.	Shear lbs.	Tension lbs.	Shear lbs.
#4-#10 (small)	#6	300	215	60	45	300	160	60	30
	#8	410	370	80	75	300	285	60	55
#6-#12 (medium)	#8	230	320	45	65	200	335	40	65
	#10	350	450	70	90	360	390	70	80

1. Allowable load capacities listed are calculated using an applied safety factor of 5.0.
2. It is not recommended to use large (#8-#14) Sharkie in hollow concrete masonry.
3. These fasteners are not recommended for use overhead or applications where holding values are critical.

Ultimate and Allowable Capacities for Sharkie in Solid Clay Brick Masonry^{1,2}

Anchor Size	Diameter Screw	Solid Clay Brick			
		Ultimate Load		Allowable Load	
		Tension lbs.	Shear lbs.	Tension lbs.	Shear lbs.
#4-#10 (small)	#6	325	225	65	45
	#8	470	400	95	80
#6-#12 (medium)	#8	235	340	45	70
	#10	495	480	100	95
#8-#14 (large)	#10	435	420	85	85
	#12	500	600	100	120

1. Allowable load capacities listed are calculated using an applied safety factor of 5.0.
2. These fasteners are not recommended for use overhead or applications where holding values are critical.

WALL ANCHORS
SHARKIE™ Wall Anchor

Ultimate and Allowable Capacities for Sharkie in Wallboard/Drywall^{1,2,3}

Anchor Size	Diameter Screw	1/2" Wallboard				5/8" Wallboard			
		Ultimate Load		Allowable Load		Ultimate Load		Allowable Load	
		Tension lbs.	Shear lbs.	Tension lbs.	Shear lbs.	Tension lbs.	Shear lbs.	Tension lbs.	Shear lbs.
#4-#10 (small)	#6	45	95	10	25	-	-	-	-
	#8	50	115	15	30	-	-	-	-
#6-#12 (medium)	#8	70	120	20	30	110	195	30	50
	#10	75	135	20	35	115	200	30	50
#8-#14 (large)	#10	80	140	20	35	120	240	30	60
	#12	85	140	20	35	135	255	35	65

1. Allowable load capacities listed are calculated using an applied safety factor of 4.0.
2. It is not recommended to use small (#4-#10) sharkie in 5/8" wallboard.
3. These fasteners are not recommended for use overhead or applications where holding values are critical.

ORDERING INFORMATION

Cat. No.	Description	Std. Box	Std. Ctn
7580	Sharkie w/flange #4-#10 (small)	100	1,000
7582	Sharkie w/flange #6-#12 (medium)	100	1,000
7584	Sharkie w/flange #8-#14 (large)	100	500

