

DEWALT

ANCHORS & FASTENERS

WOOD-KNOCKER® II+

BANG-IT®+

SQUARE RECESS

Located in center of head to eliminate anchor rotation when installing rod

PERFORATED NAILS

Allows nails to be easily removed after the formwork is stripped off

WIDE BASE

2-3/8 in. diameter base provides stability on formwork

SEALING MEMBRANE

Guides threaded rod and protects from spray insulation

CINCH NUT TECHNOLOGY

Internal locking mechanism allows for alignment when pushing rod into anchor

CONICAL SPRING

Ensures even sealing of anchor to metal deck

PRE-DRILLED HOLES

4 holes allow for fastening of anchor to deck

TOOTHED SLEEVE

Guides threaded rod and protects from spray insulation

CAST-IN-PLACE

PUSH-IN THREAD CONCRETE INSERTS



GUARANTEED TOUGH.®

DWCIPPITSS

WOOD-KNOCKER®II+ PUSH-IN THREAD

ORDERING SPECIFICATIONS

CAT#	SIZE	COLOR	QTY-BOX
PFM2610038	3/8 in.	Green	50
PFM2610012	1/2 in.	Yellow	50

PUSH-IN INSTALLATION

WOOD-KNOCKER®II+ PUSH-IN

POSITION

1.) POSITION INSERT ON FORMWORK, PLASTIC DOWN.



DRIVE

2.) DRIVE INSERT HEAD DOWN UNTIL HEAD CONTACTS PLASTIC (E.G. WOOD-KNOCKER INSTALLATION TOOL, HAMMER).

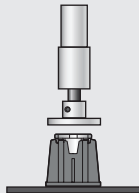

PREPARE

3.) AFTER FORMWORK REMOVAL, REMOVE NAILS AS NECESSARY (E.G. FLUSH MOUNTED FIXTURES).



ATTACH

4.) PUSH ROD/BOLT THROUGH PLASTIC CENTER (THREAD SEAL) AND FULLY SEAT STEEL ELEMENT INTO THE INSERT. ATTACH FIXTURE AS APPLICABLE (E.G. SEISMIC BRACE).

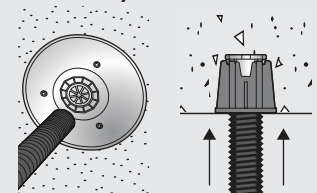

BANG-IT®+ PUSH-IN THREAD

ORDERING SPECIFICATIONS

CAT#	SIZE	COLOR	QTY-BOX
PFM3610038	3/8 in.	Green	50
PFM3610012	1/2 in.	Yellow	50

PUSH-IN INSTALLATION

BANG-IT®+ PUSH-IN

CREATE HOLE

1.) CUT (E.G. DRILL/PUNCH) A HOLE IN THE STEEL DECK TO THE HOLE SIZE REQUIRED BY THE INSERT.

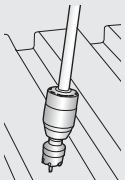

POSITION

2.) PLACE THE PLASTIC SLEEVE OF THE INSERT THROUGH HOLE IN STEEL DECK.

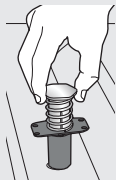

MOUNT

3.) STEP ON OR IMPACT THE INSERT HEAD TO ENGAGE. OPTIONALLY, BASE PLATE OF INSERT CAN ALSO BE ATTACHED TO STEEL DECK (E.G. USING SCREWS).



ATTACH

4.) PUSH ROD/BOLT THROUGH END OF PLASTIC SLEEVE AND FULLY SEAT STEEL ELEMENT INTO THE INSERT. TRIM AWAY / REMOVE PLASTIC SLEEVE AS NECESSARY FOR SHEAR LOADING. ATTACH FIXTURE AS APPLICABLE (E.G. SEISMIC BRACE).

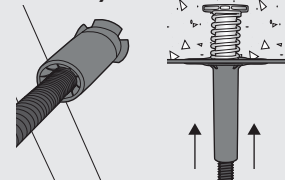

BANG-IT®+ BRIDGE BAR

DESCRIPTION

FOR USE WITH BANG-IT®+ CONCRETE INSERTS WHEN PLACED OVER ANGLED PORTION OF METAL DECK. PROVIDES ENHANCED LOCAL PLACEMENT OF BANG-IT®+ INSERTS.

SPECIFICATIONS

DESCRIPTION	PACKAGED WITH SCREWS	CAT#	QTY-BOX
Bang-It®+ Bridge Bar	No	PFM3613000	20
	Yes	PFM3613001	20

Copyright ©2021 DeWALT. The following are examples of trademarks for one or more DeWALT power tools and accessories: the yellow and black color scheme; the "D"-shaped air intake grill; the array of pyramids on the handgrip; the kit box configuration; and the array of lozenge-shaped humps on the surface of the tool.

DWCIPPITSS

GUARANTEED TOUGH.®

1-800-4-DEWALT

www.ANCHORS.DEWALT.com